

Interlock Switch

371 GuardSwitch Explosion Proof

Applications

- Explosive Environments
 - Automobile Paint Booths
 - Industrial Paint Booths
 - Chemical/Toxic Environments
 - Fertilizer Manufacturers
 - Grain Mills
- Requiring Highly Defeat Resistant Switches
- Enclosure UL classified for hazardous locations classes:
 - Class I, Group B, C, D
 - Class II, Group E, F, G
 - Class III, Divisions 1 & 2

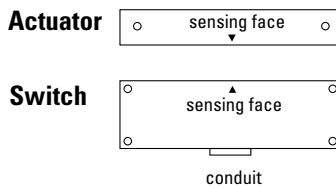
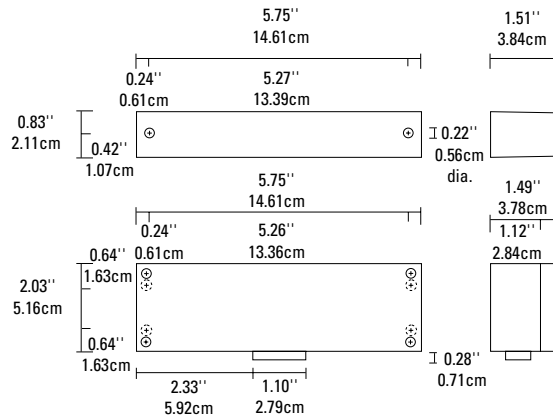

General Specifications

Enclosure	UL Explosion Proof, Black Anodized Die Cast Aluminum
Temperature Range	-40°F to 180°F (-40°C to 80°C)
Environmental	Hermetically Sealed Contact Switch Encapsulated in Polyurethane
NEMA Rating	1, 2, 5
Protection Class	IP 64
Response Time	1 msec (5.4VA); 10 msec (150VA)
Life Cycles	100,000 Under Full Load; Up to 200,000,000 Under Dry Circuit
Conduit Connection	1/2" Threaded NPT
UL	All Models



File E 22942

Order Info. Electrical Specifications

Part No.	Contact ¹ Load Rating		Switching Voltage, Max.		Switching Current, Max.		Contact Resistance	Sense Range ²		Break Range	Terminal Type
	Config.	AC DC	AC	DC	AC	DC		Max.	Min.		
371-CT	N.O.	2.5VA 2.5W	30V(@0.08A)	30V(@0.08A)	0.18A(@13.8V)	0.18A(@13.8V)	0.5 Ohms	0.5"(1.3cm)	0.25"(0.635cm)	1.2"(3.0cm)	#6 Screws
371-DT ⁴	N.O.	150VA NA	120V(@1.25A)	NA	1.25A(@120V) ³	NA	NA	0.5"(1.3cm)	0.25"(0.635cm)	1.2"(3.0cm)	#6 Screws

Warning— Each electrical rating is an individual maximum and cannot be exceeded!

¹ Configuration with actuator away from the switch

² Proximity of ferrous materials usually reduces sense range — typically by 50%. The shape and type of material cause a wide diversity of effects. Testing is required to determine actual sense range for specific applications.

³ Can withstand inrush surge up to 4 amps. Voltage drop is 1.5V, minimum switch current, 30 mA, triac output.

⁴ Do not exceed 10 switches in series.